

### Type IC, Wet & Air-Tight



Project: \_\_\_\_\_

Location: \_\_\_\_\_

Trim Finish: \_\_\_\_\_

Qty: \_\_\_\_\_

Notes: \_\_\_\_\_

### DESCRIPTION

4" Round Recessed LED With Integral Driver In Connection Box.  
Fits Where No Other Recessed Fixture Can.

### FEATURES & BENEFITS

**1/2" Thin** - Install Directly Under Joists, Maximum Layout Flexibility  
**Type IC Rated** - No Housing Required  
**Fast & Easy To Install** - Save On Labour  
**Driver Inside Connection Box** - No Junction Box Needed

### MOUNTING

Cut Hole In Ceiling And Snap Fixture In Opening With Attached Spring Clips.  
2" Above Ceiling Clearance Required For Driver.

### DIMENSIONS

ID 4 1/8"

OD 5 1/4"

Cut Out 4 1/4" to 4 1/2"

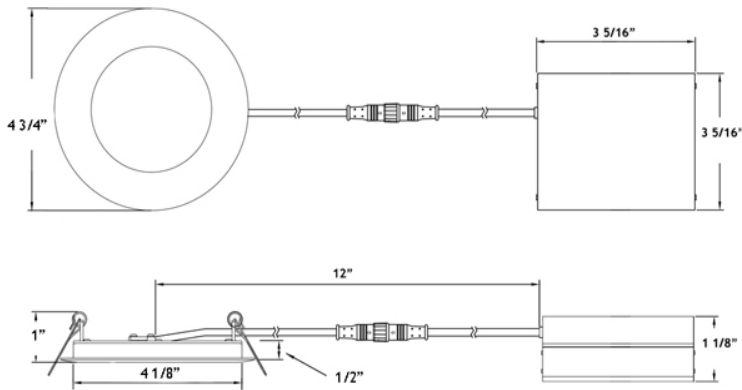

### COMPLIANCE



### Driver Included

Cable Rating FT4 / CM



### Trim Options



White



Black



Brushed Nickel

## CHARACTERISTICS

**Body:** Durable, Die Cast Aluminum Alloy for Optimal Heat Dissipation.

**Paint:** Oil Based Spray Painted - Scratch Resistant And Smooth Finish.

**LEDs:** 77 Pieces Of Custom Packaged LM80 Epistar 3014.

Guaranteed 98% Lumen Maintenance After 6,000 Hours.

Strict Binning To Ensure Consistent Light Colour.

**Driver:** 4th Generation Lotus Designed. Field Proven Since 2011.

**Connection Box:** Patented Invention By Lotus LED Lights.

Saves Contractors Labour On Installation.

**Testing:** Every Single Driver Is Powered For Minimum 24 Hours Together With The Fixture That It Is Shipped With. No Random Tests.

<b>LED lighting facts</b> <small>A Program of the U.S. DOE</small>	
Light Output (Lumens)	580
Watts	9.5
Lumens per Watt (Efficacy)	61.05
Color Accuracy Color Rendering Index (CRI)	80
Light Color Correlated Color Temperature (CCT)	3000 (Bright White)
<small>All results are according to IESNA LM-79-2008: Approved Method for the Electrical and Photometric Testing of Solid-State Lighting. The U.S. Department of Energy (DOE) verifies product test data and results.</small>	
<small>Visit <a href="http://www.lightingfacts.com">www.lightingfacts.com</a> for the Label Reference Guide.</small>	
<small>Registration Number: K53C-LQ24GY (3/23/2016) Model Number: LY4RCS 30K Type: Luminaire - Downlight</small>	

## PHOTOMETRIC DATA

Test: U:120.1V I:0.0808A P:9.456W PF:0.9750 Lamp Flux:600.656x1 lm Eff: 63.52 lm/W					
MODEL	LY4RCS 30K	Imax (cd)	213.3	S/MH (C0/180)	1.28
NOMINAL POWER (W)	0	LOR (%)	100.0	S/MH (C90/270)	1.28
RATED VOLTAGE (V)	120	TOTAL FLUX (lm)	600.66	$\eta$ UP, DN (C0-180)	0.0, 50.3
NOMINAL FLUX (lm)	600.656	CIE CLASS	DIRECT	$\eta$ UP, DN (C180-360)	0.0, 49.7
LAMPS INSIDE	1	$\eta$ up (%)	0.0	CIBSE SHR NOM	1.25
TEST VOLTAGE (V)	120	$\eta$ down (%)	100.0	CIBSE SHR MAX	1.35

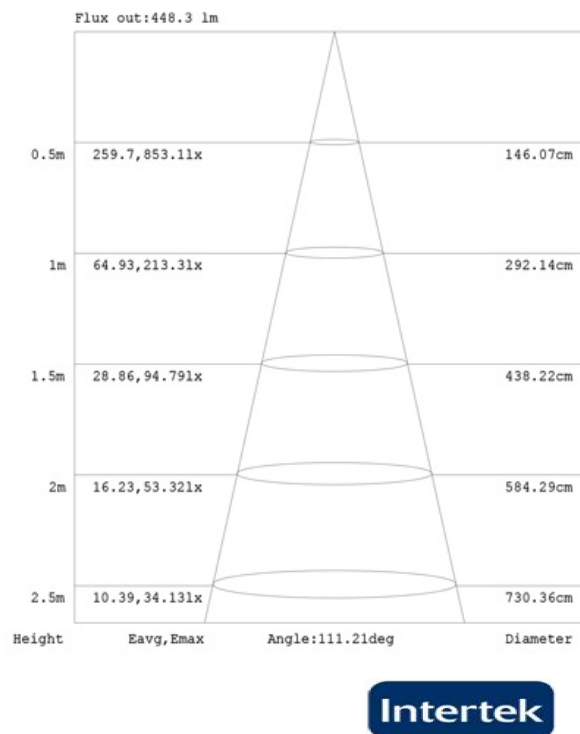
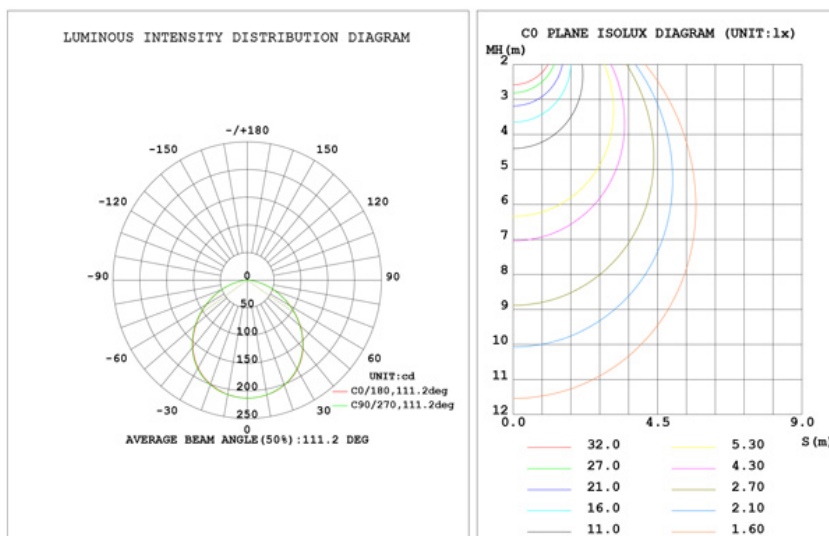

**Intertek**

## ORDERING GUIDE

Example: LY4RCS / 30K / WH

LY4RCS / 30K /

Trim Finish

WH : White

BK : Black

BN : Brushed Nickel

Order 277V - 347V Optional Driver Separately As cat # LLL-LD1535H



## ACCESSORIES



Low Voltage Extension Cables  
6ft - cat # EXC6, 20ft - cat # EXC20  
Max 40 ft Allowed. FT4 / CM rated



Flat Rough-In Plates - cat # RIP4



Flanged Rough-In Plate - cat # LRP4



Goof Ring OD 5 3/4"  
White - cat # GR4 Black - cat # GR4-BK



**Lotus  
LED  
Lights**

## Warehouses

Vancouver

Toronto

Las Vegas

Naples

Philadelphia

Dallas

Seattle

Chicago

Denver

tel: 1-844-24-LOTUS (56887)

fax: 1-877-561-6306

[www.lotusLEDlights.com](http://www.lotusLEDlights.com)