

Slim Surface LED

Low Profile, Easy to Install, Applicable to Junction Box Installation

*Slim surface LED is characterized by a completely flat lens with a narrow flange, giving it an architecturally pleasing look
Ideal for residential, office, retail, hospitality, etc.*

Model # ADS7R9



- **Edge-lit technology to produce a smooth uniform lighting effect**

- This 5/8" thick luminaire is easy to install on standard j-boxes with a quick snap
- Construction: plastic white translucent acrylic lens
- Apertures: round & square
- Glare controlling lens for comfortable light distribution
- Provides an affordable alternative to Fire-Rated boxes
- Input voltage: AC 120V 50/60Hz
- Solves the problem of limited plenum space
- Driver-On-Board technology eliminates the demand of a traditional LED driver
- Color rendering index: 90
- 100%-10% dimming capability, this fixture is compatible with industry standard TRIAC/ELV dimmers
- Lifetime 50,000 hours
- Beam angle: 120°



Sizes

7" Round
Ø201mm
15W
900Lm

Color Temperature Options

- Soft White: 3000K
- Neutral White: 4000K
- Cool White: 5000K

Trim Options



Dimensions

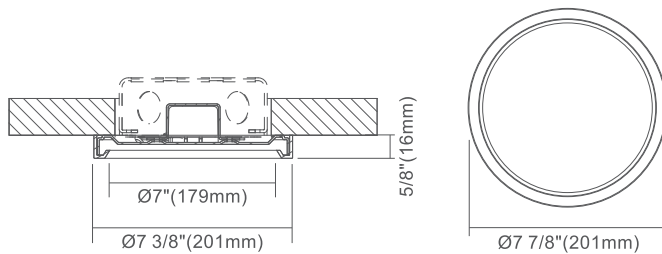

7" Plastic Round

Installation

4" J-Box

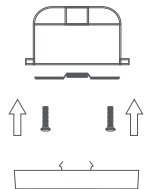

Accessories included:
Attach mounting bracket
to J-box
Click downlight into
mounting bracket

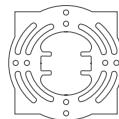

Mounting
Bracket



J-Box
Screws



Wire
Nuts



LED
Adapter