

Emergency Battery Backup for 7" Round LED Slim Surface

LED intelligent emergency light, 90 minute operation from battery, 24 hours recharge time
Model # EMB-SF001

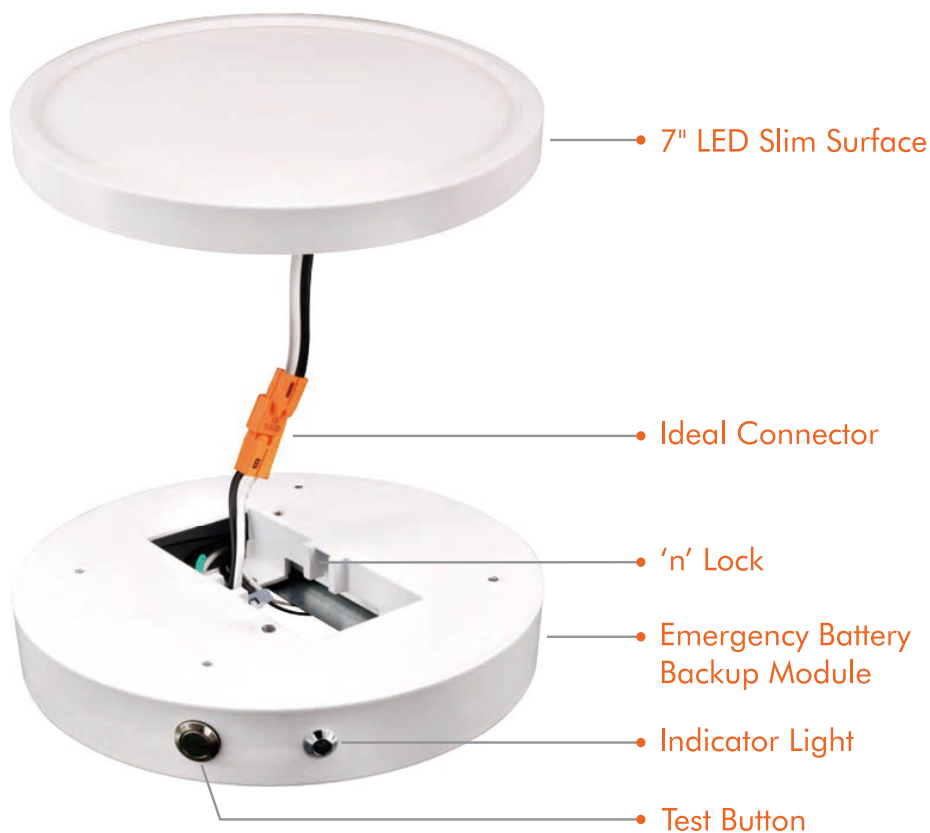



Test Button

1. While main power is on:

- A quick press of the test button(<3 seconds), simulates the "main power outage" or emergency mode". The light fixture will come in this case. It will be running on battery power.
 - Pressing test button for 3-6 seconds puts the unit into the monthly self test routine (approx.3 minutes run time).
 - Press test button again anytime to stop the routine.
 - As the system runs its check on the battery power and circuit connections, the LED indicator will flash green@1 cycle/ second.
 - Pressing test button for >6 seconds puts the unit into the annual self test routine. (up to 90 minutes run time)
- Note: The system will completely discharge the battery during this routine).

- Press test button again anytime to stop the routine.
- As the system runs its more detailed annual test on the battery power and circuit connections, the LED indicator will quickly flash green@3 cycle/ second.

2. While in Emergency Status (mains power outage):

- Pressing test button for <6 seconds shuts off the unit. press again to turn it back on.
- Pressing test button for >6 seconds completely shuts off emergency output. In this state, the system will not function unless the mains power is reset.

LED Indicator Colors/ Functions

- Red: Battery is charging
- Green: Battery at full charge
- Yellow: Check system-possible battery replacement needed or system maintenance required
- Green Flashing: Monthly or annual test mode is running
- Off: Indicates a power outage when the battery backup unit is in emergency mode the LED indicator will be Off
- Minimum Charge Time: 24hours



LED Source



Emergency Time



Safety Protection



Self Test

Features

For Emergency Battery Backup Module

- Self test function
- Lithium battery backup module
- 24 hours recharge time
- ≥ 90 minutes operation from battery
- Switching time: < 1 second
- Over-charge/ discharge protection
- Test button
- Output: operates the installed lamps for 90 minutes
- Durable die-cast aluminum material

For 7" LED Slim Surface

- 5/8" thick luminaire, 15W, 900Lm
- 100%-10% dimming capability, this fixture is compatible with industry standard TRIAC/ELV dimmers
- Lifetime rated for greater than 50,000 hours
- Input voltage: AC 120V 50/60Hz
- Edge-lit technology to produce a smooth uniform lighting effect
- High quality plastic material
- Certification: ETL, Energy Star, JA8, Title24

Dimensions

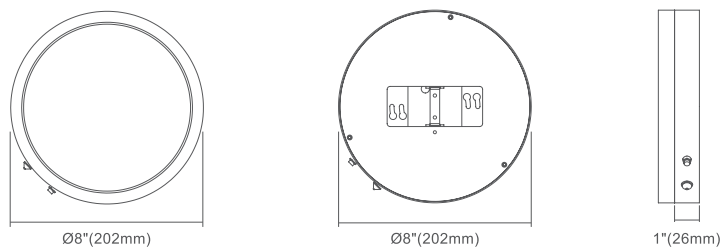

Emergency Battery Backup Module for 7" LED Slim Surface

Installation (For 7" LED Slim Surface)

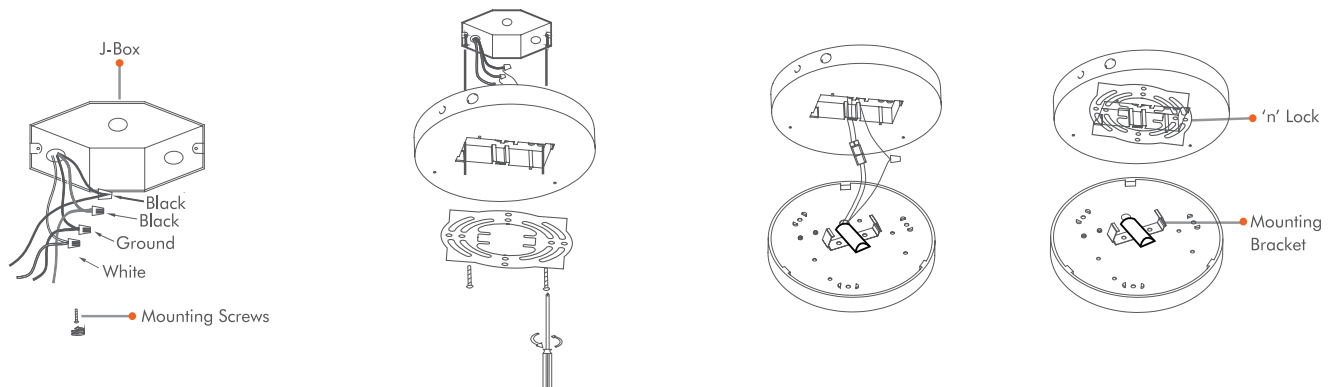

Turn off/ disconnect power at circuit breaker. Typical junction box wiring has only white & black switched wires controlled by wall switch for on/ off or dimming. Ensure the junction box has an additional set of unswitched wires (continuous) main power wires available. If necessary, add these wires as shown. (Label these additional wires correct connections can be made)

Screw the emergency backup unit (EMBU) into the junction box using the 2X8/32 screws provided. Then using the wire nut provided, connect the three (3) cables available for connection into junction box

- Connect the "Switched Line" to the black switched power cable coming from the junction box.
- Connect the "Continuous Mains Power" from the battery backup box to the continuous mains black wire from the junction box.
- Connect the "Neutral" white wire from the battery backup together with the other two neutral white wires coming
- Screw the mounting plate on the EMBU

Make electrical connections from the LED lighting fixture with the battery backup.

- Use the orange connector already supplied.
- Be sure to connect the ground wire coming from the lighting fixture.

Pop 'n' lock into place

- Feed all wires into the battery backup box and raise the lighting fixture to the ceiling.
- Align the mounting bracket of the fixture with the mounting plate on the EMBU, push the fixture towards EMBU until it pops.