



# DNA042CU2-W-600-R-P

## Smart Wi-Fi Dimmer Triac Forward Phase Cut with Remote

Project: \_\_\_\_\_

Location: \_\_\_\_\_

Qty: \_\_\_\_\_

Notes: \_\_\_\_\_

### DESCRIPTION

Smart Dimmer Wi-Fi or Bluetooth controllable Forward Phase Cut  
With Remote Control, Mounting Brackets and Wall Plates

### FEATURES & BENEFITS

- Intuitive Design for Easy Operation
- Control by Tuya or Smart Life apps via Wi-Fi or Bluetooth
- Single Pole or 3-Way Wiring (Neutral Wire Required)
- Start Up & Power Off levels memory
- Brightness Level & Status Indicator lights
- Fine Adjustments of Minimum & Maximum brightness
- Press twice quickly for maximum or minimum brightness
- Press and hold for gradual dimming up & down
- Fits in multi gang boxes without need to break tabs
- Over Load & Over Temperature Protection

SPECIFICATION	
Input Voltage	120V 60Hz
Approved Location	Indoor / dry locations
Minimum / Maximum Load	LED / CFL 3W - 200W
	Incandescent 15W - 600W
Wiring Mode	Single Pole or 3-Way
Neutral Wire Required	Yes
Dimming Mode	Forward Phase Cut (Leading Edge)
Paring Capacity	1 dimmer to max 3 remotes / 1 remote to max 10 dimmers
Smart Control	Wi-Fi 2.4 GHz or Bluetooth (not mesh)
App for control	Tuya or Smart Life
Operating Temperature	0°C to + 40°C (32°F to 104°F)
Operating Humidity	10% - 90% RH
Certifications	c ETL us, FCC
Warranty	3 Year

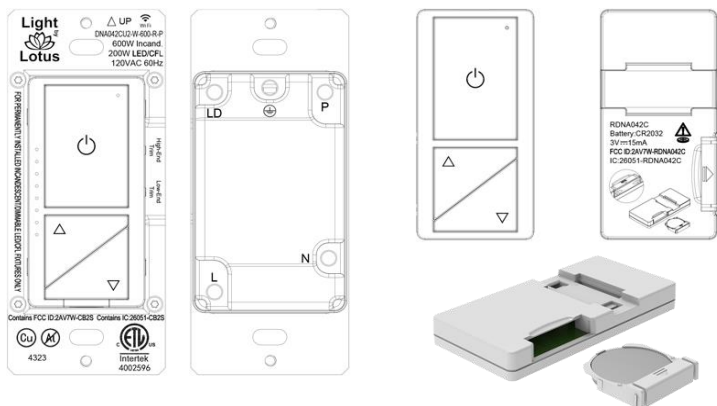

### [INSTALLATION INSTRUCTIONS](#) download

[SETUP GUIDE with Tuya app](#) download

[SETUP GUIDE with Smart Life app](#) download

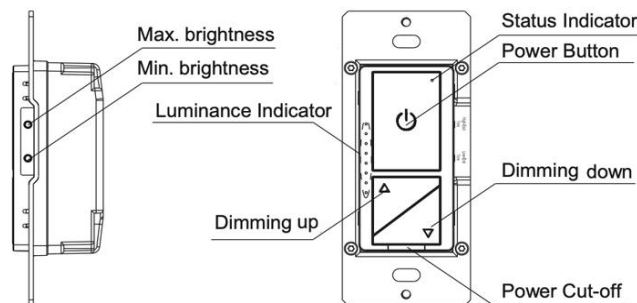

### ORDERING GUIDE model **DNA042CU2-W-600-R-P**

#### INCLUDED IN PACKAGE



Dimmer, Remote Control, 3 mounting brackets for remote,  
2 Screwless Decora Wall Plates

White in stock. Black & Grey available by custom order

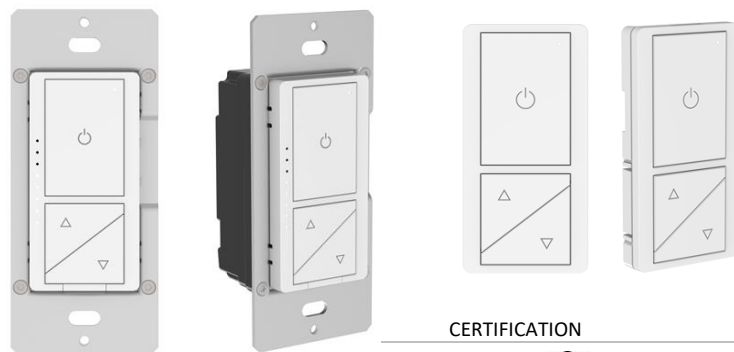

#### CERTIFICATION



#### Lotus LED Lights USA

250 H Street # 301, Blaine WA 98230 tel 360-200-5500  
Hainesport NJ, Naples FL, Vancouver WA

[www.LotusLEDLights.com](http://www.LotusLEDLights.com)

mailing addresses  
warehouses

#### Lotus LED Lights CANADA

1080 Cliveden Ave # 6, Delta BC V3M 6G6 tel 604-538-3090  
Delta BC & Mississauga ON