

# EMB-SF001

## Emergency Battery Backup for ADS7R9



Project: \_\_\_\_\_

Location: \_\_\_\_\_

Qty: \_\_\_\_\_

Notes: \_\_\_\_\_

### DESCRIPTION

Emergency battery backup for 7" slim surface LED model ADS7R9  
Guarantees 2 hours operation from battery in case of power outage

### FEATURES & BENEFITS

- Self test function
- Switch time less than 1 second
- Over charge / discharge protection
- Durable die-cast aluminum with Li-ion battery
- 3 hours operating for model ADS7R9 at around 50% brightness
- Photometric files for initial brightness, after 30 minutes and after 90 minutes discharging available on our website

DIMENSIONS OD 8" Thickness 1"

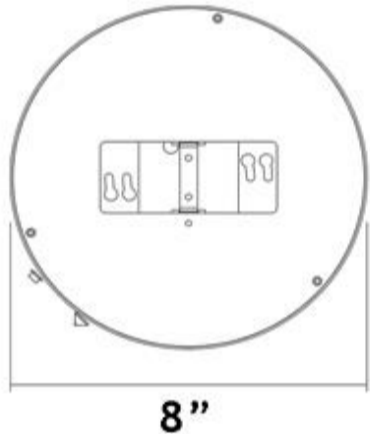

SPECIFICATION	
Applications	Healthcare, Offices, Hotels, Hospitality, etc.
Input Voltage	120 V AC 50/60 Hz
Charging Time	24 hours
Charging Current	185 mA
Switching Time	< 1 second
Output Voltage	65 V DC
Discharging Time	3 hours with 2 hours guaranteed
Brightness	around 50% of the full power
Output Current	45 mA
Output Power	3 W
Approved Location	Damp
Ambient Temperature	-4°F (-20°C) to +104°F (+40°C)
Certification	cETLus
Battery Life	500 Charging Cycles
Warranty	5 Year



### INSTALLATION INSTRUCTIONS

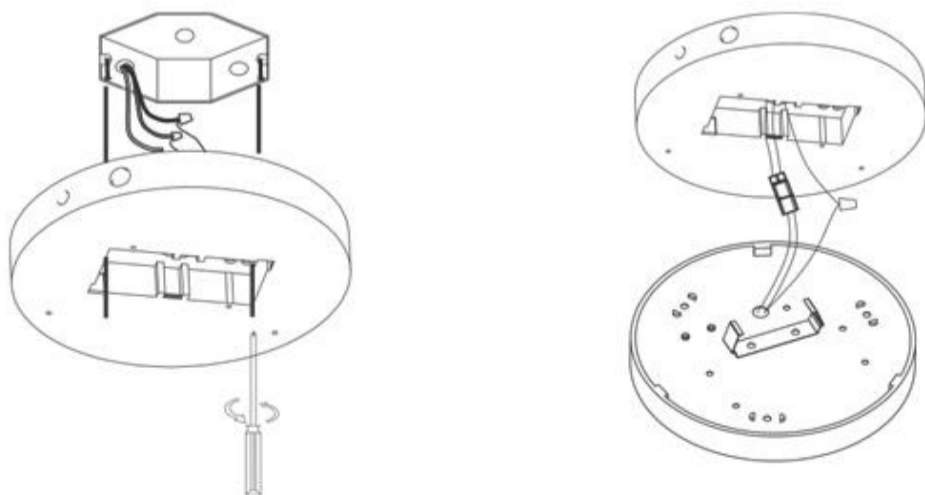

ACCESSORIES Sold Separately



Empty Surface Mount Backbox of EMB-SF001  
[model # EMBS](#)

COMPATIBLE FIXTURE [ADS7R9](#)

Please note that only the single CCT 3000K and 4000K versions are compatible  
**ADS7R9-5CCT is NOT compatible**

ORDERING GUIDE model **EMB-SF001**