



# INSTALLATION INSTRUCTIONS SMART SLIM LED DOWNLIGHT

**IMPORTANT :** Read all instructions before installing fixtures. Retain for future reference.

**SAFETY :** For your safety, this fixture must be wired in accordance to local electrical codes and ordinances. All work should be done by a qualified electrician.

**WARNING :** Make certain power is OFF from the electrical panel before starting installation or attempting any maintenance. Indoor installation only.

**TOOLS REQUIRED:**

- Saw
- Measuring Tape
- Electrical Wiring (use type and gauge suitable for application to connect the fixtures)

**PRE-INSTALLATION:**

1. Turn power OFF from the electrical panel before starting installation.
2. Locate a suitable position to plate the fixture and open in accordance to the cut-hole dimensions (refer to Hole Cut Table for appropriate size).
3. Run electrical wire from the switch (power supply) through the mounting hole-use NMD90 Romex or BX cable.

**DRIVER WIRING:**

1. Open the hardwire box swing cover and remove the appropriate knockout (s).
2. Insert the electrical supply cable through the knockout and secure with a cable connector (sold separately).
3. Using wire nuts, connect green ground wire of cable to green wire on box. Connect white wire of cable to white wire of box. Connect black wire of cable to black wire of box. (Fig.1)
4. Place all wiring and connections back in to the box and close the cover.
5. Insert hardwire box through the mounting hole. (Fig.2)  
New construction applications: Hardwire box shall be firmly secured to studs, joists, or similar fixed structural units.  
Remodel applications: Do not require the hardwire box to be firmly secured after the mounting plates, studs, joists, or structural units have been concealed.

**FIXTURE INSTALLATION:**

1. Connect the fixture to the hardwire box by inserting and twisting the male/female connectors. (Fig.3)
2. Push spring loaded clips on the fixture upwards and insert fixture base in to the mounting hole. Release the clips and fixture will be pulled flush to the ceiling. (Fig.4)
3. Once assembly is complete, turn on power to confirm fixture is working properly.

**IMPORTANT :** Lire toutes les instructions avant d'installer les appareils. Conserver pour référence future.

**SÉCURITÉ :** Pour votre sécurité, cet appareil doit être câblé conformément aux codes et règlements électriques locaux. Tout travail doit être effectué par un électricien qualifié.

**AVERTISSEMENT :** Assurez-vous que le courant est coupé à partir du panneau électrique avant de commencer l'installation ou l'entretien. Installation à l'intérieur seulement.

**OUTILS REQUIS :**

- Scie
- Mètre Ruban
- Câblage électrique (utiliser seulement le type adapté à l'application pour ces appareils)

**PRÉ-INSTALLATION :**

1. Coupez l'électricité à partir du panneau électrique avant de commencer l'installation.
2. Trouver un endroit approprié pour placer le trou ouvrir un trou conformément aux dimensions coupe-trous (voir le tableau approprié à la taille).
3. Exécutez le fil électrique de l'interrupteur (alimentation) à travers le trou de montage-utiliser un câble NMD90 Romex ou BX.

**CÂBLAGE DU PILOTE :**

1. Ouvrez le couvercle de la boîte de raccordement et enlever les formes tracées.
2. Insérez le câble d'alimentation électrique par le trou et le fixer avec un connecteur de câble (vendu séparément).
3. À l'aide des écrous, connectez le fil vert du câble au fil vert sur la boîte. Brancher le fil blanc du câble au fil blanc de la boîte. Connectez le fil noir du câble au fil noir de la boîte. (Fig.1)
4. Placez tout le câblage et les connexions dans la boîte et fermez le couvercle.
5. Insérez à travers le trou de montage. (Fig.2)  
Application nouvelles construction : Boite de raccordement doit être fixé solidement aux poteaux, solives ou sur des structures similaires.  
Application Remodeler : Nécessite pas la boite de raccordement d'être fixe solidement aux plaques de montage, goujons, solives ou structures dissimulés.

**INSTALLATION D' APPAREILS :**

1. Connectez le appareil au la boîte de raccordement par l'insertion et en tournant les connecteurs mâle/femelle. (Fig.3)
2. Pousser les clavettes sur le montage vers le haut et insérez la base de fixation dans le trou de montage. Relâchez les clavettes et l'appareil sera tiré au ras du plafond. (Fig.4)
3. Lorsque l'assemblage est terminé, branché le courant et confirmer appareil fonctionne correctement.

Hole Cut Size / Taille Trou Découpé	
3" Round with Baffle	Ø3-3/8"(Ø85)
4" Round with Baffle	Ø4-1/4"(Ø108)
6" Round and Square	Ø6-1/4"(Ø158)
4" Round with Baffle	Ø4-1/4"(Ø108)
6" Round with Baffle	Ø6-1/4"(Ø158)

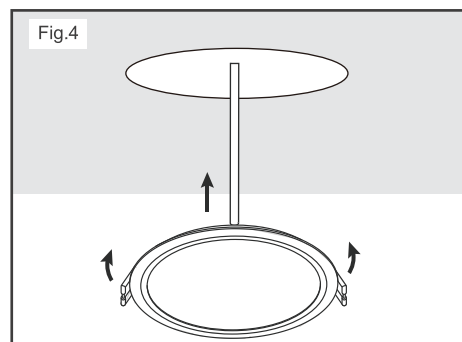
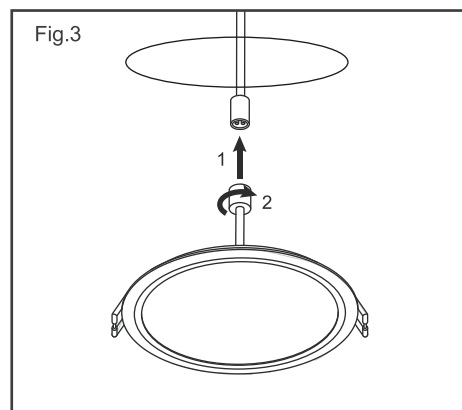
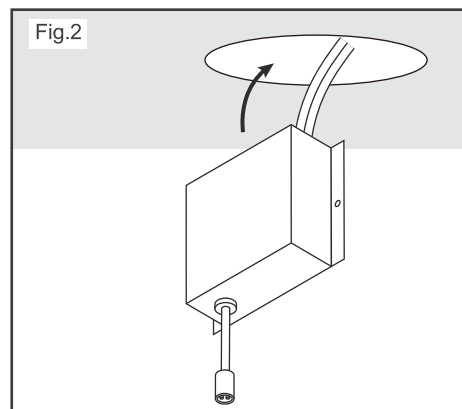
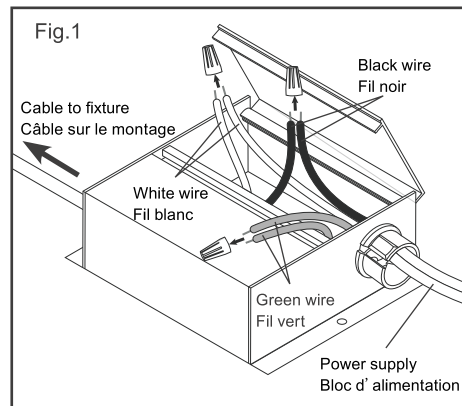

# Install the Smart life APP

1. Find and install the Smart life app on Apple Store, Google Play.

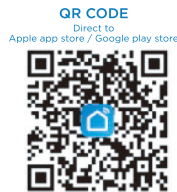
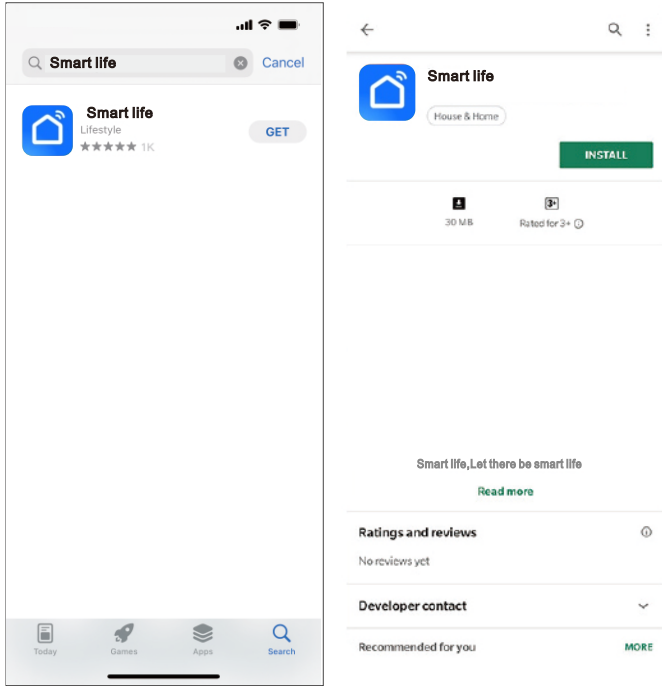

2. Register a Smart life account.

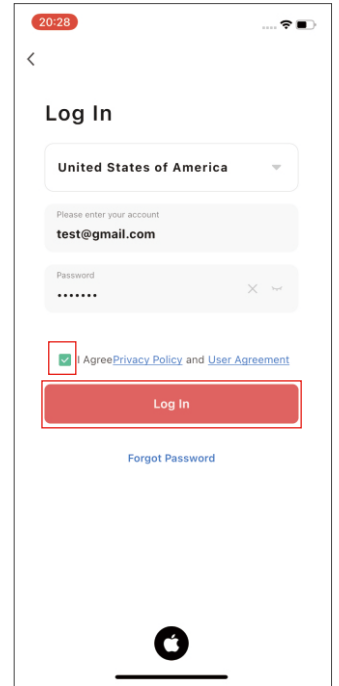
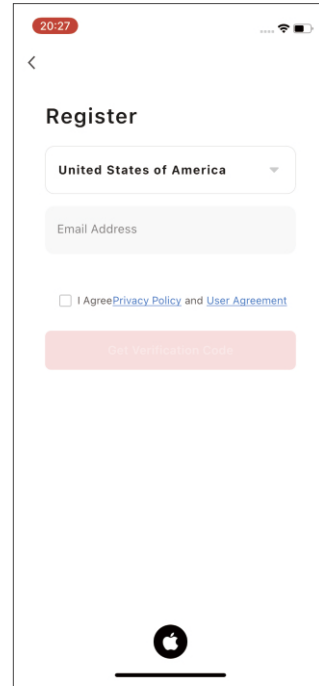

Enter your mobile phone number or email address.

Log into the App.

Note: Please select your region and country.

3. Connect: Easy Mode.

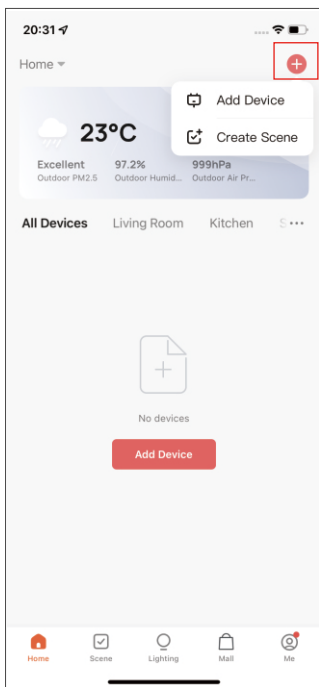

STEP 1

Open the Smart life App. In the top corner of the Devices screen, click (+) the Home, click "+" and "Add Device".



STEP 2

Choose Lighting >> Light Source (BLE+Wi-Fi) Select upper right corner "EZ Mode".

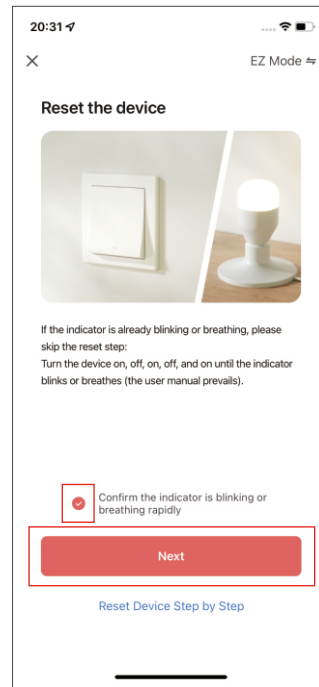

STEP 3

Make sure light rapidly flashing white. If not, reset to reach Easy Mode to connect press "Next" in the App.

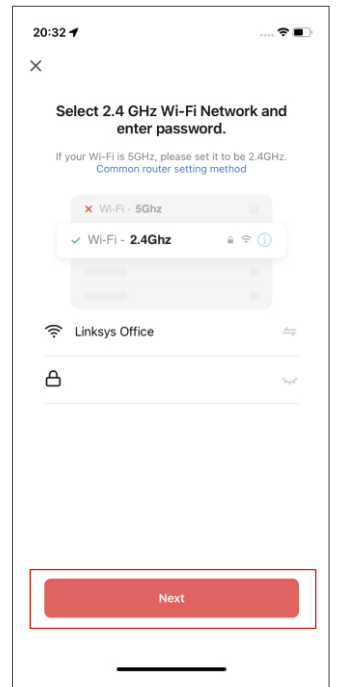

STEP 4

Enter your WiFi network and password.

NOTE: Smart life can't connect to 5GHz networks. \*If the connection fails try to connect using AP Mode

## 4. Connect:AP Mode

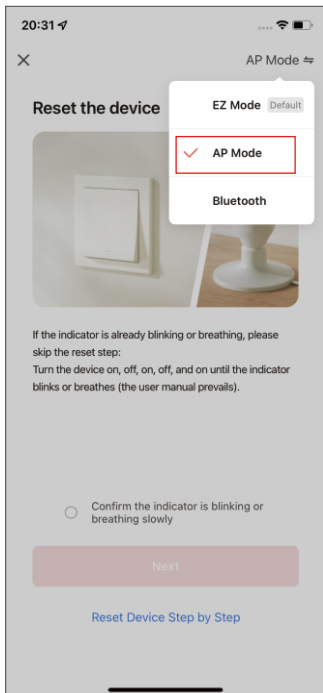

### STEP 1

Open the **Smart life** App. In the top corner of the Home, click "+" choose "Light Source(BLE+Wi-Fi)". select upper right corner "AP Mode".

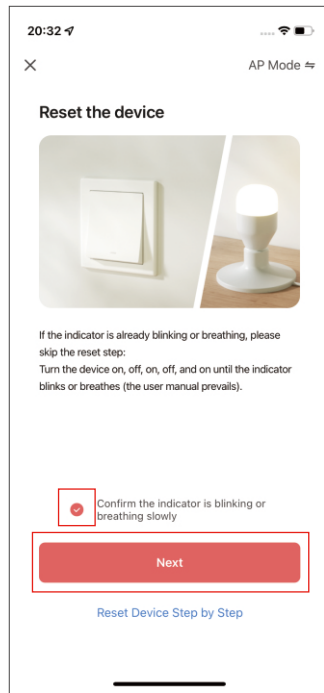

### STEP 2

Make sure light is slowly flashing white. If not, reset to reach AP Mode.

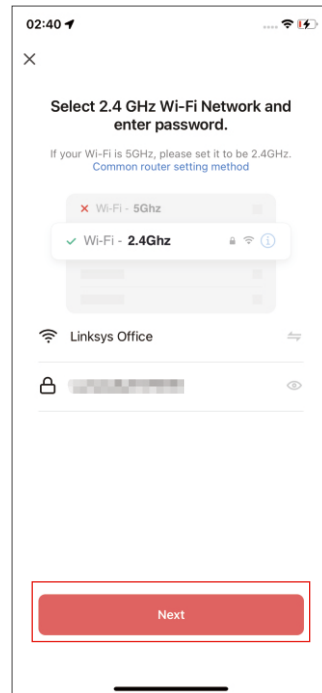

### STEP 3

Enter your WiFi network and password.

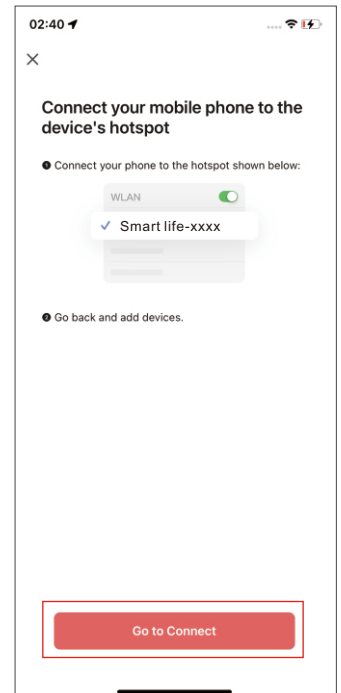

### STEP 4

Press "Next" and enter your Wi-Fi details.



### STEP 5

Follow the instructions to choose the device from your Wi-Fi list.

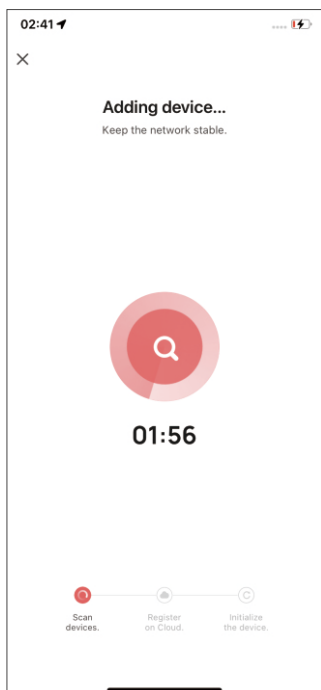

### STEP 6

The **Smart life** App will connect to your devices.

## 5. Connect:Bluetooth

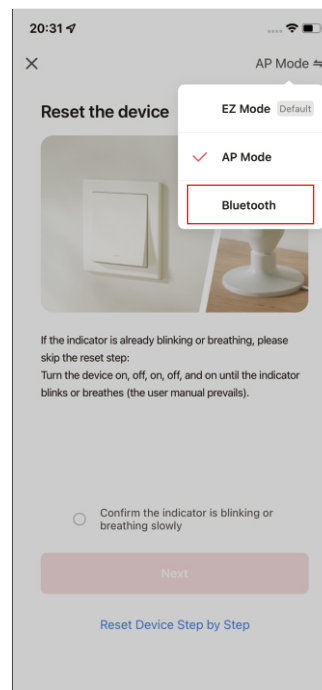

### STEP 1

Open the **Smart life** App. In the top corner of the Devices screen, click "+". Choose "Light Source(BLE+Wi-Fi)". Select upper right Corner "Bluetooth".

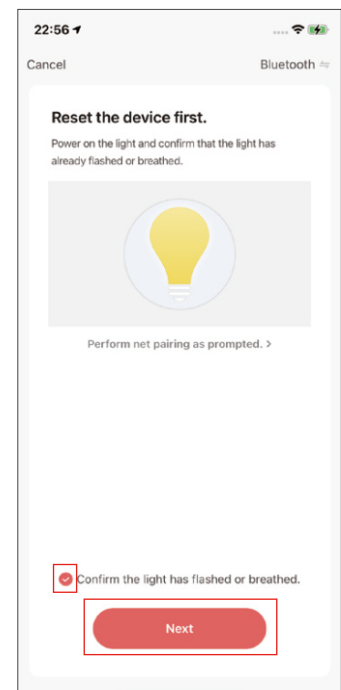

### STEP 2

Make sure light is rapidly flashing white. If not, reset to reach Easy Mode to connect Press "Next" in the App.

**NOTE: Smart life can't connect to 5GHz networks.**  
\*If the connection fails try to connect using AP Mode

# Group Control

1. Log in to Smart life APP, tap the smart device and enter into, click "⋮" in the top right corner.

2. Click "Create Group", then select a device and save.

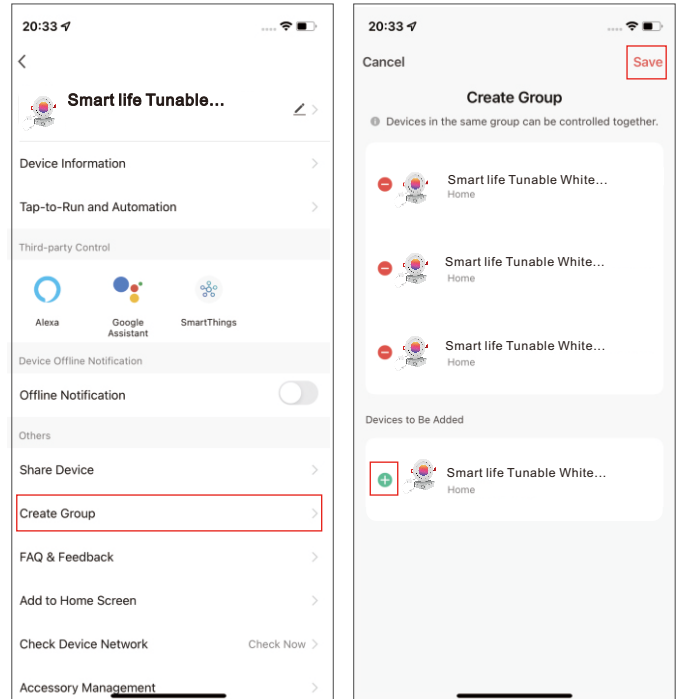
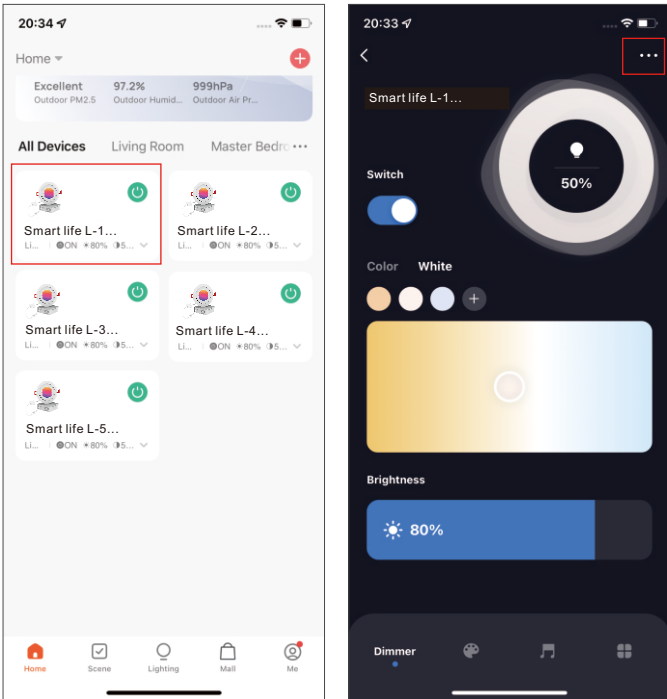

3. You can reset the group name and save it, and the group can control devices.

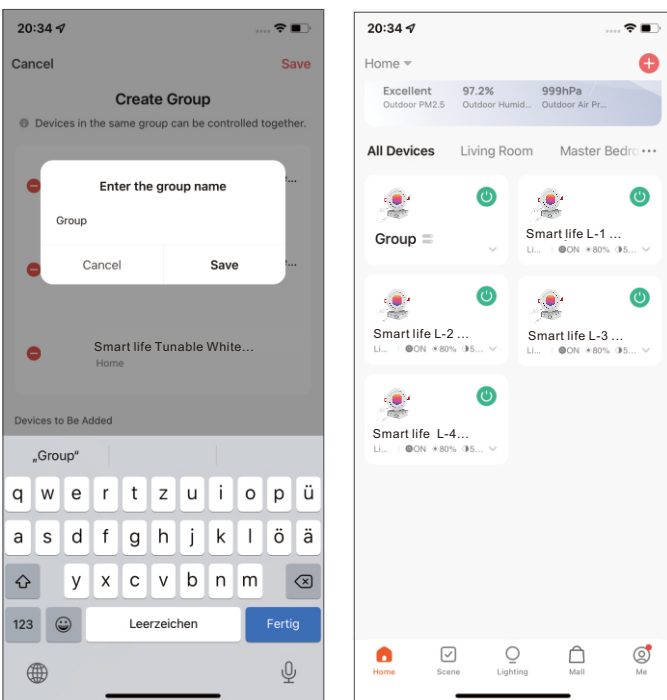

# VOICE CONTROL GUIDE

## Name and Control Each Device by Voice



## Voice Control Quick Guide for Amazon Alexa

1. Log in to Smart life APP, tap the smart device and enter into, click "✎" in the top right corner.
2. Tap "Alexa" in Third-party Control.
3. Tap "Sign In With Amazon".

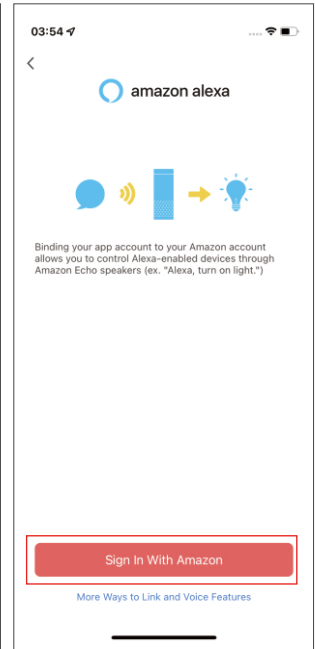
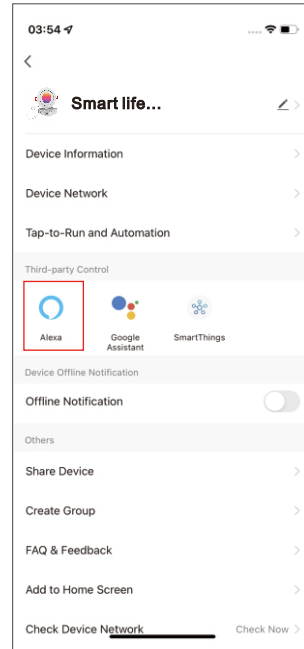

4. Tap "Allow";

5. Linked successfully, when add new device, there is no need to link again, just discover new device in Alexa.

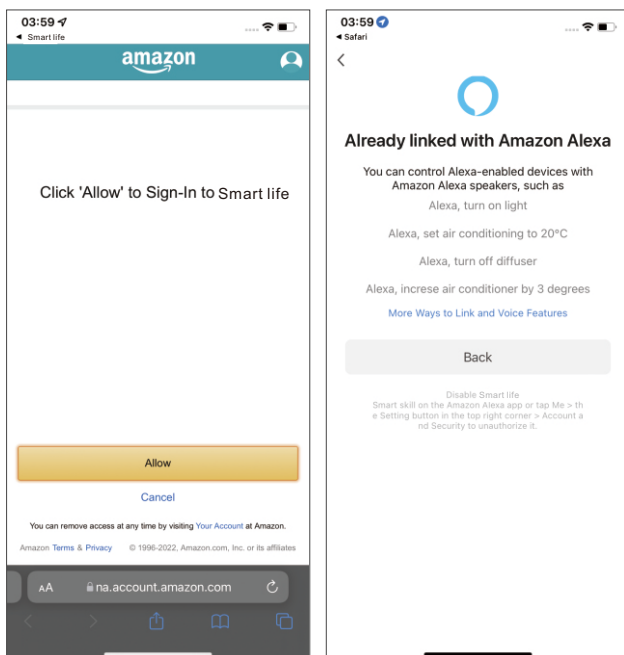

To control your Smart life device, just ask Alexa.

Make sure your devices are already set up using the Smart life app.

Things you can say\*:

"Alexa, discover my devices."

"Alexa, turn on the bedroom light."

"Alexa, set the bedroom light to orange."

"Alexa, turn off the coffee machine."

"Alexa, set the living room to 50%."

"Alexa, dim porch light."

\*Some commands require compatible devices.

## Voice Control Quick Guide for Google Assistant

1. Log in to **Smart life** app, tap the smart device and enter into, click "✎" in the top right corner.

2. Tap "Google Assistant" in Third-party Control.

3. Tap "Link with Google Assistant".

4. Click "Agree and link";

5. Linked successfully, when add new device, there is no need to link again, just discover new device in Google Home.

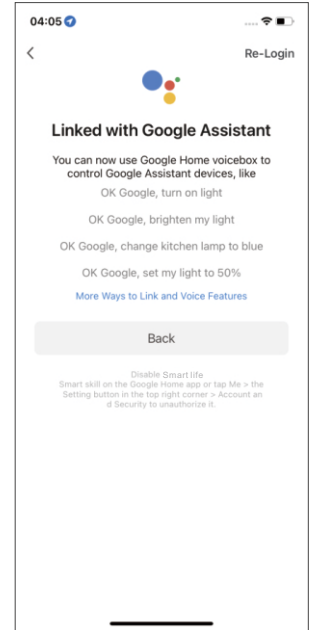
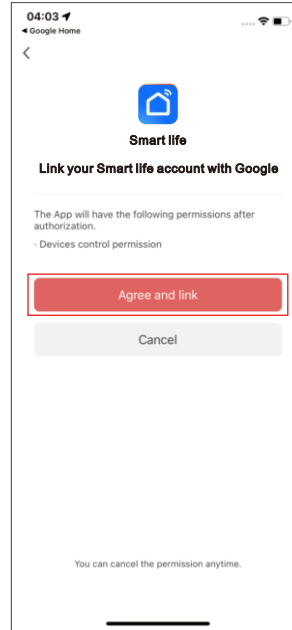
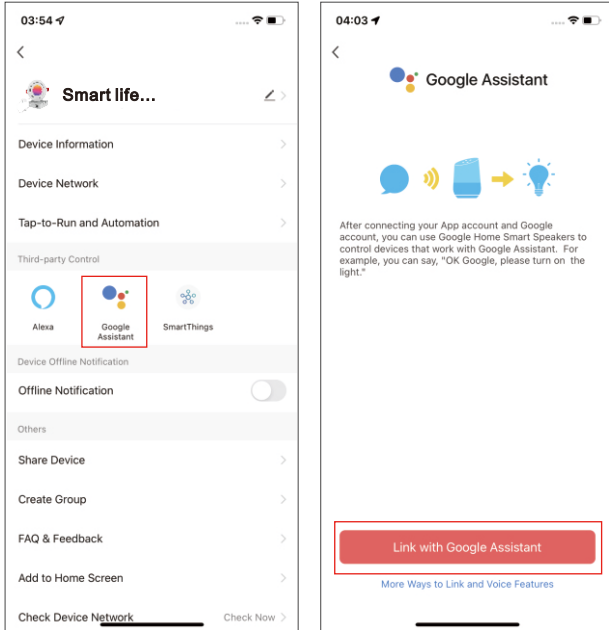

To control your **Smart life** smart device, just say "Hey Google", and ask.

Make sure your devices are already set up using the **Smart life** app.

Things you can say\*:

"Hey Google, turn on all the lights in my bedroom."

"Hey Google, turn off the light."

"Hey Google, set the bedroom light to orange."

"Hey Google, turn off the coffee machine."

"Hey Google, set the living room to 50%."

"Hey Google, dim porch light."

\*Some commands require compatible devices.